





Cable Protection Glands Polyamide

Cable protection glands with lamellar clamping

- For cable bending protection.
- Easy assembly.
- High quality strain relief and sealing, reliable performance for standard industrial applications.
- Up-to-date international approvals.

Technical Details

Material	Body, Cap	PA 6 (Polyamide 6)	
	Seal	CR (Chloroprene)	
Ingress Protection Rating		IP 68 - 5 Bar, 30 min	
		IP 66	
Flammability		V2 according to UL94	
Operating Temperature		Permanent	Intermittent
		-20 °C to +100 °C	-30 °C to +150 °C
Thread Type		<ul style="list-style-type: none"> • Metric EN 60423 • PG DIN 40430 • NPT ANSI B1.20.1 • Gas ISO 228 • Other thread types also available upon request. 	
Cable Type		Non armoured	
Accessories		<ul style="list-style-type: none"> • Lock nuts • Reducing seals • Flat cable seals • Multihole seals • Gaskets (Washers) 	
		<ul style="list-style-type: none"> • Different Seal types available. • In compliance with DIN EN 62444. • All accessories must be ordered separately. • We recommend the use of lock nuts and gaskets to ensure IP rating for rough surfaces or through holes. • Some approvals do not cover all sizes. 	
Remarks		Other colors on request: <ul style="list-style-type: none"> • RAL 5015 (blue) • RAL 9003 (white) • RAL 3020 (red) 	

Approvals	Certificate Number	Standards
	134171	DIN EN 62444
	115116_0_000	CSA C22.2
	E199260	UL514B CSA22.2 No 18.3-12 CSA22.2 No 94.2-15
TYPE 4X		UL50E
	SERCOVAM RES 107572	UL514B §8.26.7
	E-14046	EN62444

For more approvals: see our webpage.

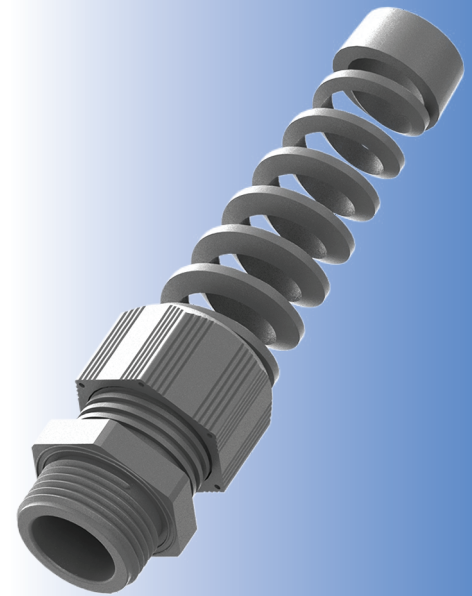

Cable Protection Glands Polyamide

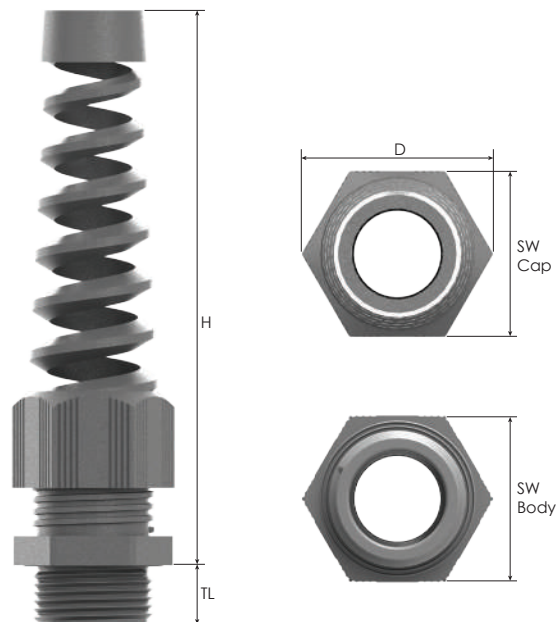

Thread Type METRIC acc. to EN 60423										
Outer Thread Size (Male)	Clamping Range Ø min-max mm	Outer Thread Length TL mm	Spanner Width		Outer Ø D mm	max. Height H mm	Part Number			Minimum Order Quantity
			Cap SW Cap mm	Body SW Body mm			RAL 7035 light grey	RAL 7001 grey	RAL 9005 black	
M12x1,5	2,0 - 5,0	8,0	15	15	16,6	58,0	BISP-1S	BISP-0S	BISP-2S	2000
	2,0 - 5,0	10,0	15	15	16,6	58,0	BISP-1SM	BISP-0SM	BISP-2SM	2000
	2,0 - 5,0	15,0	15	15	16,6	58,0	BISP-1SL	BISP-0SL	BISP-2SL	2000
	3,0 - 6,5	8,0	15	15	16,6	58,0	BMSP-1S	BMSP-0S	BMSP-2S	2000
	3,0 - 6,5	10,0	15	15	16,6	58,0	BMSP-1SM	BMSP-0SM	BMSP-2SM	2000
	3,0 - 6,5	15,0	15	15	16,6	58,0	BMSP-1SL	BMSP-0SL	BMSP-2SL	2000
M16x1,5	3,0 - 7,0	10,0	22	22	25,1	83,2	BISP-11	BISP-01	BISP-21	1000
	3,0 - 7,0	15,0	22	22	25,1	83,2	BISP-11L	BISP-01L	BISP-21L	1000
	5,0 - 10,0	10,0	22	22	25,1	83,2	BMSP-11	BMSP-01	BMSP-21	1000
	5,0 - 10,0	15,0	22	22	25,1	83,2	BMSP-11L	BMSP-01L	BMSP-21L	1000
M20x1,5	5,0 - 9,0	10,0	24	24	27,6	96,5	BISP-12	BISP-02	BISP-22	750
	5,0 - 9,0	15,0	24	24	27,6	96,5	BISP-12L	BISP-02L	BISP-22L	750
	6,0 - 12,0	10,0	24	24	27,6	96,5	BMSP-12	BMSP-02	BMSP-22	750
	6,0 - 12,0	15,0	24	24	27,6	96,5	BMSP-12L	BMSP-02L	BMSP-22L	750
	7,0 - 12,0	10,0	27	27	30,5	106,4	BISP-13	BISP-03	BISP-23	500
	7,0 - 12,0	15,0	27	27	30,5	106,4	BISP-14	BISP-04	BISP-24	250
	10,0 - 14,0	10,0	27	27	30,5	106,4	BMSP-13	BMSP-03	BMSP-23	500
	10,0 - 14,0	15,0	27	27	30,5	106,4	BMSP-14	BMSP-04	BMSP-24	250
M25x1,5	9,0 - 16,0	10,0	33	33	37,8	118,9	BISP-15	BISP-05	BISP-25	250
	9,0 - 16,0	15,0	33	33	37,8	118,9	BISP-16	BISP-06	BISP-26	250
	13,0 - 18,0	10,0	33	33	37,8	118,9	BMSP-15	BMSP-05	BMSP-25	250
	13,0 - 18,0	15,0	33	33	37,8	118,9	BMSP-16	BMSP-06	BMSP-26	250





Cable Protection Glands Polyamide

Cable protection glands with lamellar clamping

- For cable bending protection.
- Easy assembly.
- High quality strain relief and sealing, reliable performance for standard industrial applications.
- Up-to-date international approvals.

Technical Details

Material	Body, Cap	PA 6 (Polyamide 6)	
	Seal	CR (Chloroprene)	
Ingress Protection Rating	IP 68 - 5 Bar, 30 min		
	IP 66		
Flammability	V2 according to UL94		
Operating Temperature	Permanent	-20 °C to +100 °C	
	Intermittent	-30 °C to +150 °C	
Thread Type	<ul style="list-style-type: none"> • Metric EN 60423 • PG DIN 40430 • NPT ANSI B1.20.1 • Gas ISO 228 • Other thread types also available upon request. 		
Cable Type	Non armoured		
Accessories	<ul style="list-style-type: none"> • Lock nuts • Reducing seals • Flat cable seals • Multihole seals • Gaskets (Washers) 		
	<ul style="list-style-type: none"> • Different Seal types available. • In compliance with DIN EN 62444. • Accessories must be ordered separately. • We recommend the use of lock nuts and gaskets to ensure IP rating for rough surfaces or through holes. • Some approvals do not cover all sizes. 		
Remarks	Other colours on request:		
	<ul style="list-style-type: none"> • RAL 5015 (blue) • RAL 9003 (white) • RAL 3020 (red) 		

Approvals	Certificate Number	Standards
	134171	DIN EN 62444
	115116_0_000	CSA C22.2
	E199260	UL514B CSA22.2 No 18.3-12 CSA22.2 No 94.2-15
TYPE 4X		UL50E
	SERCOVAM RES 107572	UL514B §8.26.7
	E-14046	EN62444

For more approvals: see our webpage.

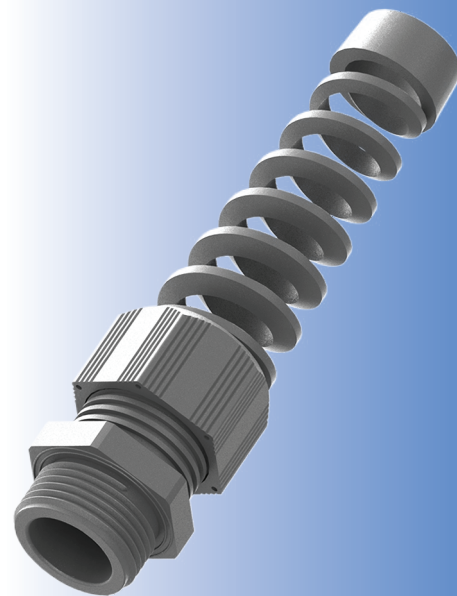

Cable Protection Glands Polyamide

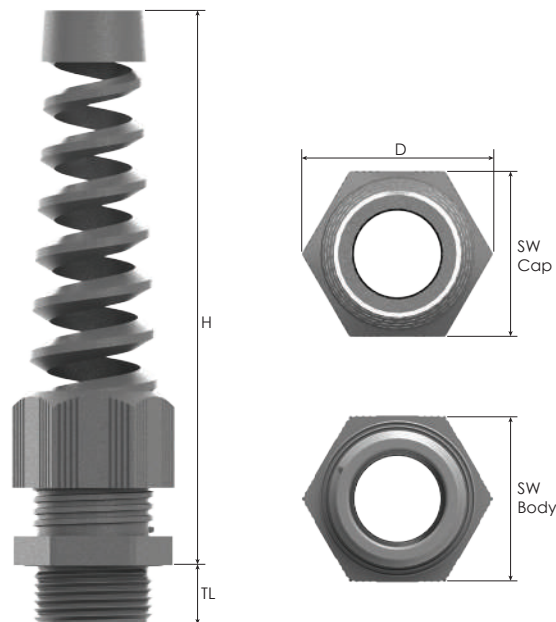

Thread Type **NPT** acc. to ANSI B1.20.1

Outer Thread Size (Male)	Clamping Range Ø min-max mm	Outer Thread Length TL mm	Spanner Width		Outer Ø D mm	max. Height H mm	Part Number			Minimum Order Quantity
			Cap SW Cap mm	Body SW Body mm			RAL 7035 light grey	RAL 7001 grey	RAL 9005 black	
NPT 3/8"	3,0 - 7,0	15,0	22	22	25,1	83,2	BNSPA-11R	BNSPA-01R	BNSPA-21R	1000
	5,0 - 10,0	15,0	22	22	25,1	83,2	BNSPA-11	BNSPA-01	BNSPA-21	1000
NPT 1/2"	5,0 - 9,0	15,0	24	24	27,6	96,5	BNSPB-12R	BNSPB-02R	BNSPB-22R	750
	6,0 - 12,0	15,0	24	24	27,6	96,5	BNSPB-12	BNSPB-02	BNSPB-22	750
	7,0 - 12,0	15,0	27	27	30,5	106,4	BNSPC-12R	BNSPC-02R	BNSPC-22R	500
	10,0 - 14,0	15,0	27	27	30,5	106,4	BNSPC-12	BNSPC-02	BNSPC-22	500
NPT 3/4"	9,0 - 16,0	15,0	33	33	37,8	118,9	BNSPD-13R	BNSPD-03R	BNSPD-23R	250
	13,0 - 18,0	15,0	33	33	37,8	118,9	BNSPD-13	BNSPD-03	BNSPD-23	250

Thread Type **PG** acc. to DIN 40430

Outer Thread Size (Male)	Clamping Range Ø min-max mm	Outer Thread Length TL mm	Spanner Width		Outer Ø D mm	max. Height H mm	Part Number			Minimum Order Quantity
			Cap SW Cap mm	Body SW Body mm			RAL 7035 light grey	RAL 7001 grey	RAL 9005 black	
PG 7	2,0 - 5,0	8,0	15	15	16,6	58,0	BSRP-11	BSRP-01	BSRP-21	2000
	3,0 - 6,5	8,0	15	15	16,6	58,0	BSSP-11	BSSP-01	BSSP-21	2000
PG 9	2,0 - 6,0	8,0	19	19	21,5	68,4	BSRP-12	BSRP-02	BSRP-22	1500
	4,0 - 8,0	8,0	19	19	21,5	68,4	BSSP-12	BSSP-02	BSSP-22	1500
PG 11	3,0 - 7,0	8,0	22	22	25,1	83,2	BSRP-13	BSRP-03	BSRP-23	1000
	5,0 - 10,0	8,0	22	22	25,1	83,2	BSSP-13	BSSP-03	BSSP-23	1000
PG 13,5	5,0 - 9,0	10,0	24	24	27,6	96,5	BSRP-14	BSRP-04	BSRP-24	750
	6,0 - 12,0	10,0	24	24	27,6	96,5	BSSP-14	BSSP-04	BSSP-24	750
PG 16	7,0 - 12,0	10,0	27	27	30,5	106,4	BSRP-15	BSRP-05	BSRP-25	500
	10,0 - 14,0	10,0	27	27	30,5	106,4	BSSP-15	BSSP-05	BSSP-25	500
PG 21	9,0 - 16,0	11,0	33	33	37,8	118,9	BSRP-16	BSRP-06	BSRP-26	250
	13,0 - 18,0	11,0	33	33	37,8	118,9	BSSP-16	BSSP-06	BSSP-26	250

Thread Type **G** acc. to G ISO 228

Outer Thread Size (Male)	Clamping Range Ø min-max mm	Outer Thread Length TL mm	Spanner Width		Outer Ø D mm	max. Height H mm	Part Number			Minimum Order Quantity
			Cap SW Cap mm	Body SW Body mm			RAL 7035 light grey	RAL 7001 grey	RAL 9005 black	
G 3/8"	3,0 - 7,0	11,0	22	22	25,1	83,2	BFSR-11	BFSR-01	BFSR-21	1000
	5,0 - 10,0	11,0	22	22	25,1	83,2	BFSP-11	BFSP-01	BFSP-21	1000
G 1/2"	5,0 - 9,0	10,0	24	24	27,6	96,5	BFSR-12	BFSR-02	BFSR-22	750
	6,0 - 12,0	10,0	24	24	27,6	96,5	BFSP-12	BFSP-02	BFSP-22	750
	7,0 - 12,0	11,0	27	27	30,5	106,4	BFSR-13	BFSR-03	BFSR-23	500
	10,0 - 14,0	11,0	27	27	30,5	106,4	BFSP-13	BFSP-03	BFSP-23	500
G 3/4"	9,0 - 16,0	12,0	33	33	37,8	118,9	BFSR-14	BFSR-04	BFSR-24	250
	13,0 - 18,0	12,0	33	33	37,8	118,9	BFSP-14	BFSP-04	BFSP-24	250